

**Guidelines for
Pyrobel / Pyrobelite
in Insulating Glass Unit**

AGC

2008

Page n°

1.	General	3.
2.	Pyrobel/Pyrobelite edge work	3.
3.	Component descriptions	3.
4.	Absolute limits	6.

1. GENERAL

This document gives the acceptable components which can be used with IGUs manufactured with Pyrobel/Pyrobelite glass:

- To provide a fire resistance performance (report Warringtonfire 158884 Issue 3).
- To comply with EN1279-4.

The IGU manufacturer is responsible for carrying out conformity assessment in accordance with EN 1279 and for submitting the IGUs products to a notified certification body.

2. PYROBEL/PYROBELITE EDGE WORK

We recommend arising Pyrobel/Pyrobelite edges for use in insulating glass unit.

3. COMPONENT DESCRIPTIONS

3.1 Drawing of cross section of the sealed edge for an insulating glass in combination with Pyrobel/Pyrobelite glass.

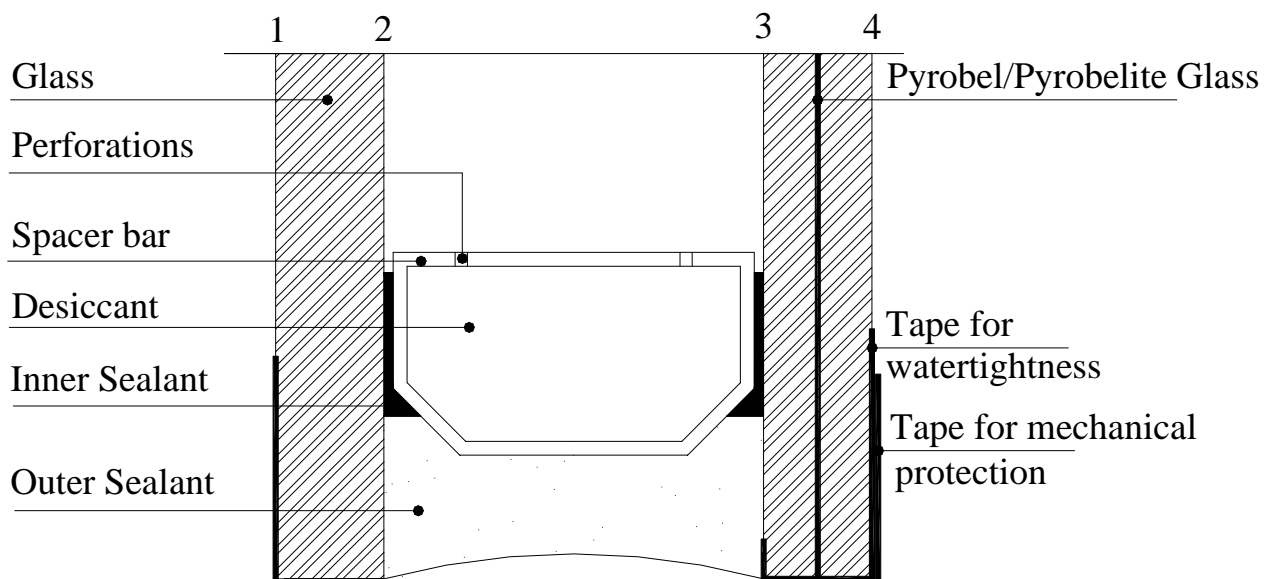

3.2 Glass panes

Together with Pyrobel/Pyrobelite glass in position 3-4, the following glass panes can be applied in position 1-2:

- Float glass according EN 572-2, 572-8, 572-9
- Drawn sheet glass according EN 572-4 and EN 572-9
- Patterned glass according EN 572-5 and EN 572-9
- Toughened glass according EN 12150-1 and EN 12150-2
- Heat soaked thermally toughened soda lime glass according EN 14179-1 and 14179-2
- Heat strengthened glass according EN 1863-1 and EN 1863-2
- Laminated safety glass according EN 12543-2 and EN 14449
- Coated glass according EN 1096-2 and EN 1096-4, any coated glass is acceptable.
- Coated glass according EN 1096-3 and EN 1096-4, any coated glass is acceptable.

3.3 Outer sealant

- Polysulfide
- Polyurethane
- Silicone

3.4 Inner sealant

- Polyisobutylene

3.5 Spacers

- Aluminium (widths from 5.5mm to 26mm)
- Mild steel (widths from 5.5mm to 26mm)
- Galvanised steel (widths from 5.5mm to 26mm)
- Stainless steel (widths from 5.5mm to 26mm)

3.6 Gaseous fillings

Gas type	Function
Air	Thermal insulation
Argon	Thermal insulation
Krypton	Thermal insulation

3.7 Desiccants

- Zeolite granules

3.8 Tape for mechanical protection

Manufacturers	Product references
KMB Klebetechnik GmbH	K-LA5025-4720 THN K-LA5025-PE200 Bi K-Aludense

KMB KLEBETECHNIK

✉ Breisenbachstrasse, 97
D-44357 Dortmund - Gemany

☎ +49 231 935 010 0

☎ +49 231 935 010 33

<http://www.kmb-klebetechnik.de/>
info@kmb-klebetechnik.de

3.9 Tape for watertightness

Manufacturers	Product references
Eurobands industrie NV-SA	Alu Eurometal 4500

EUROBANDS NV-SA

✉ I.Z. Huttegem, 6
B-8570 Anzegem, BELGIUM

☎ +32 56 724511

☎ +32 56 724513

<http://www.eurobandstapes.eu>
info@eurobands.be

3.10 Aluminium Georgian Bar profiles

Manufacturers	Product references
Erbslöh Aluminium GmbH	Georgian bar profile
Profilglass S.p.A.	Georgian bar profile

<http://www.erbsloeh.de>
<http://www.profilglass.it>

4. Absolute limits for taping in combination with Pyrobel/Pyrobelite glass

